

Planta Baixa
Sinalização R-1 "Parada Obrigatória"
DETALHAMENTO SINALIZAÇÃO

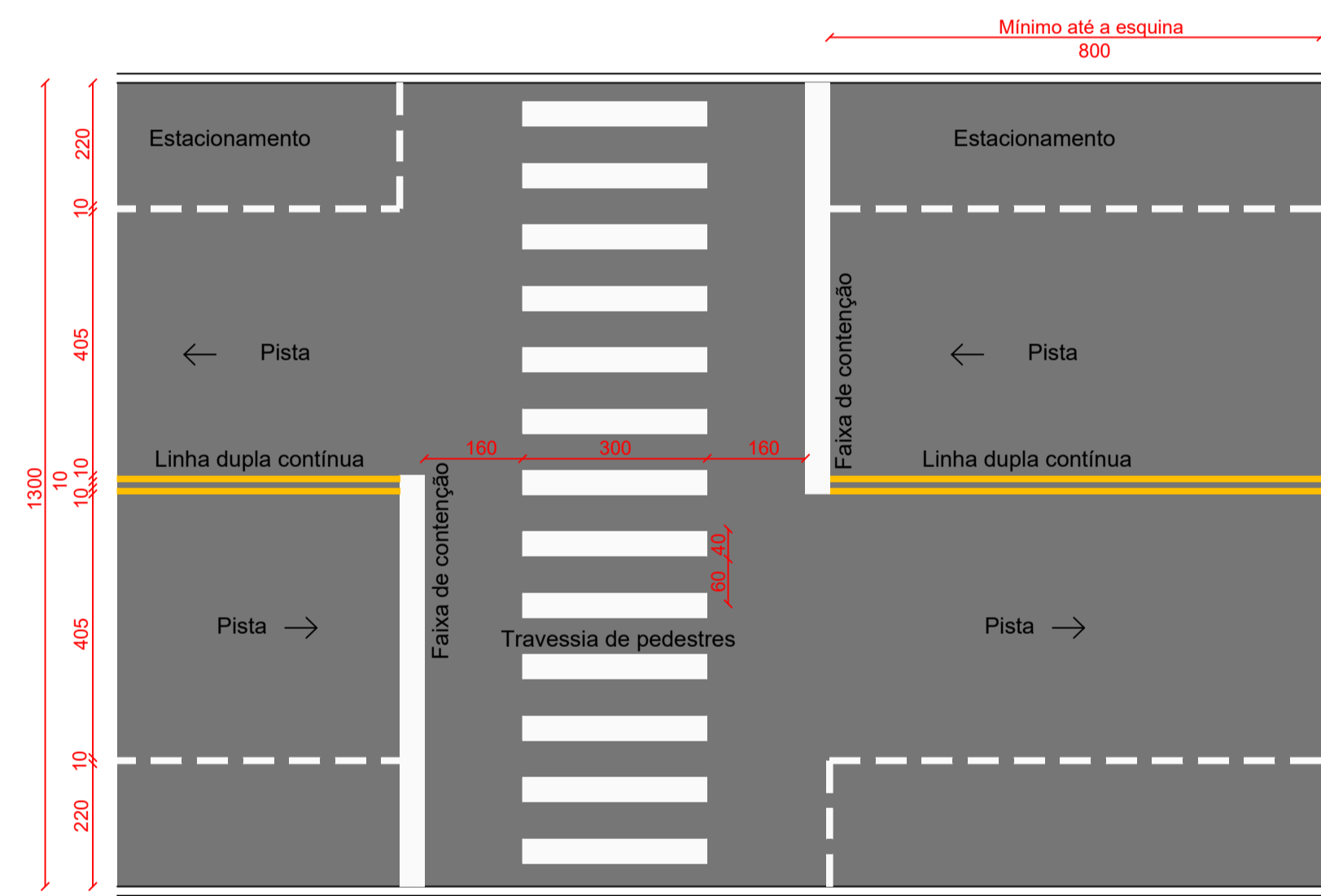

Detalhe sinalização viária horizontal
Esc.: Sem escala

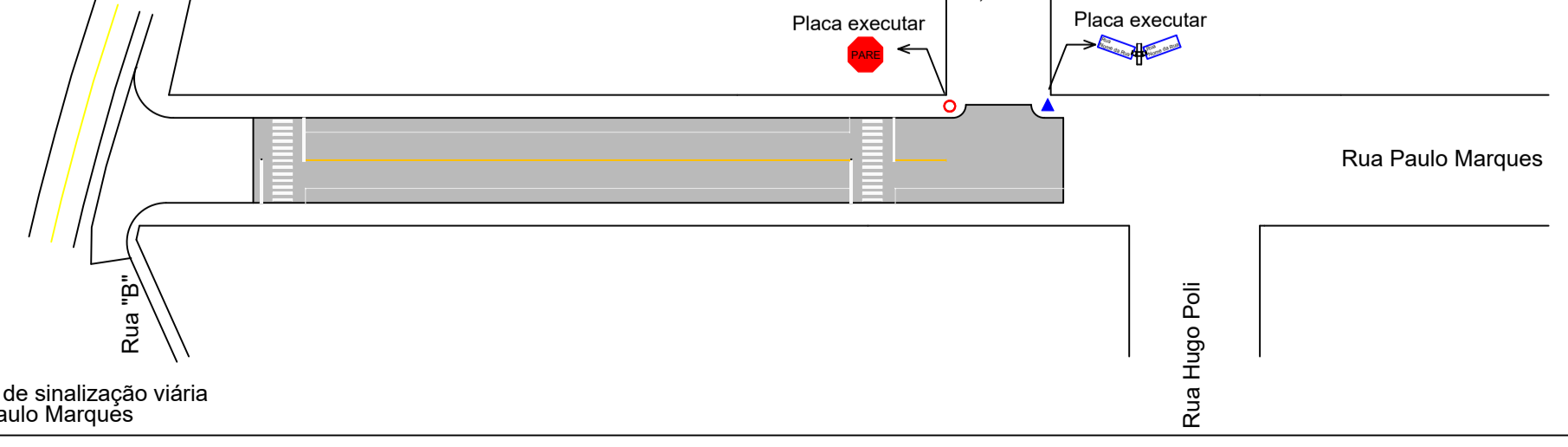
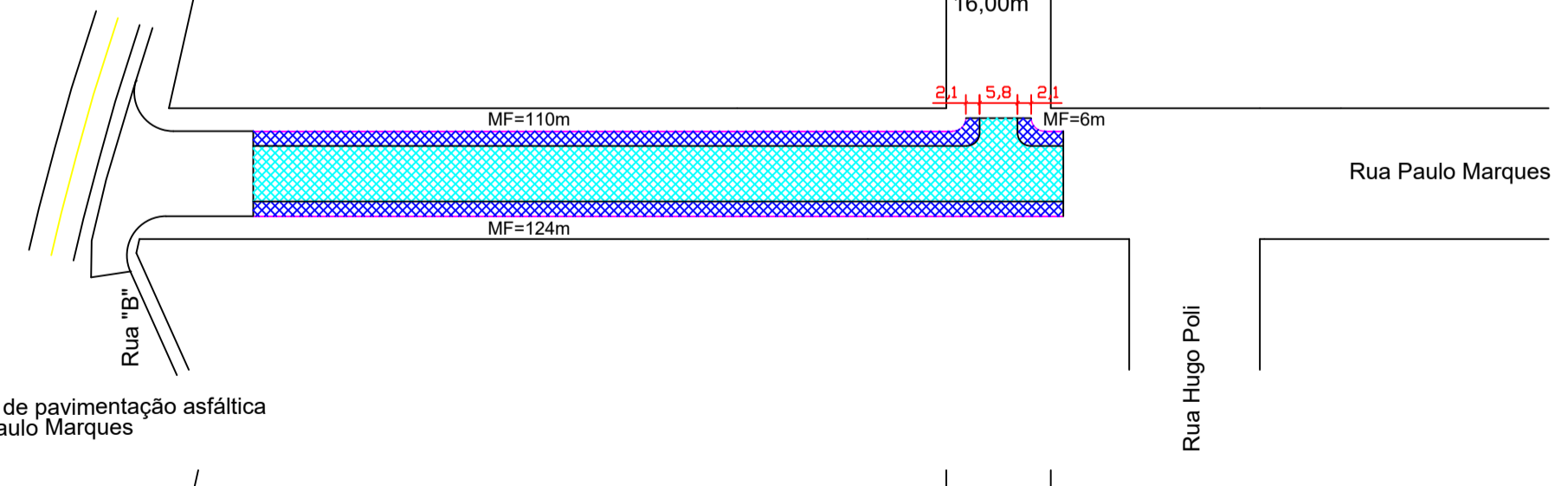
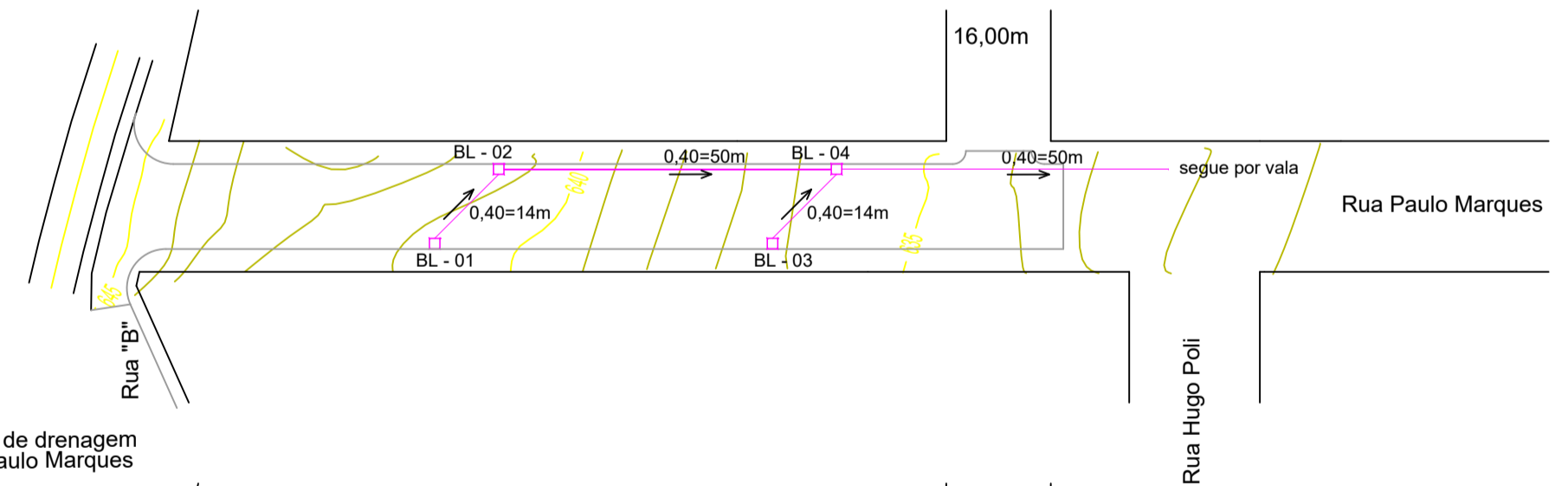
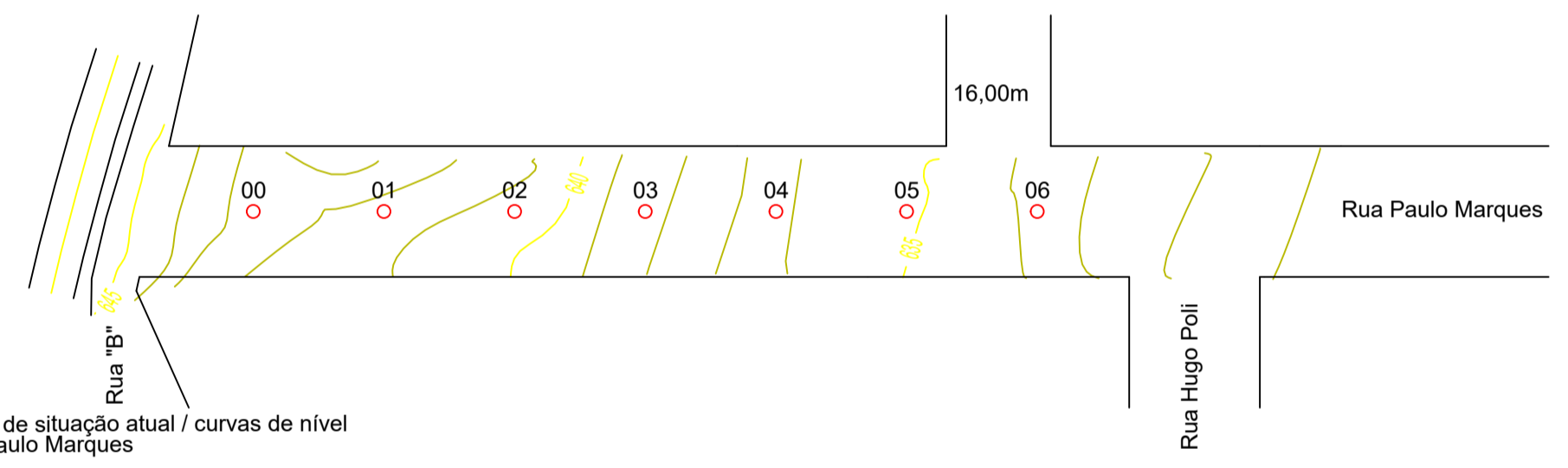
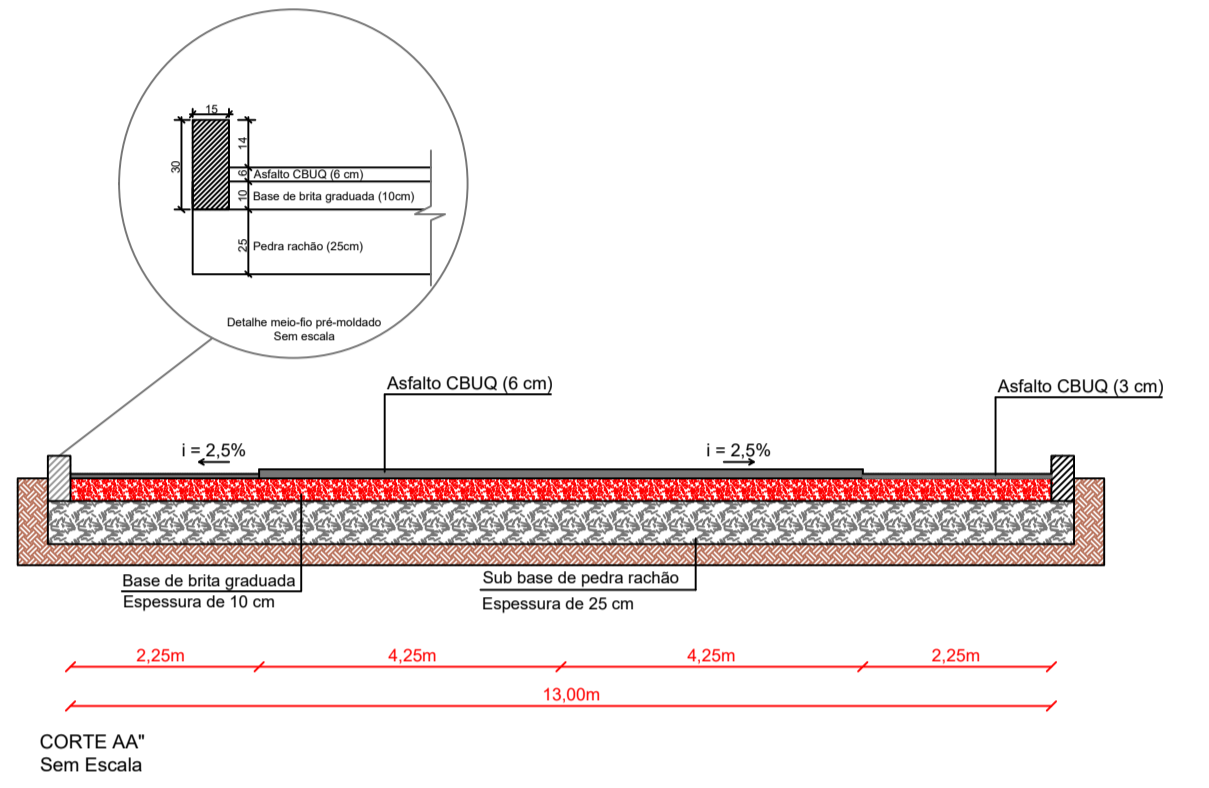
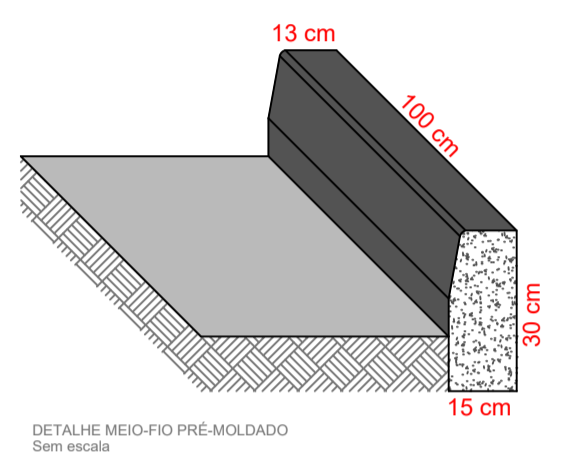
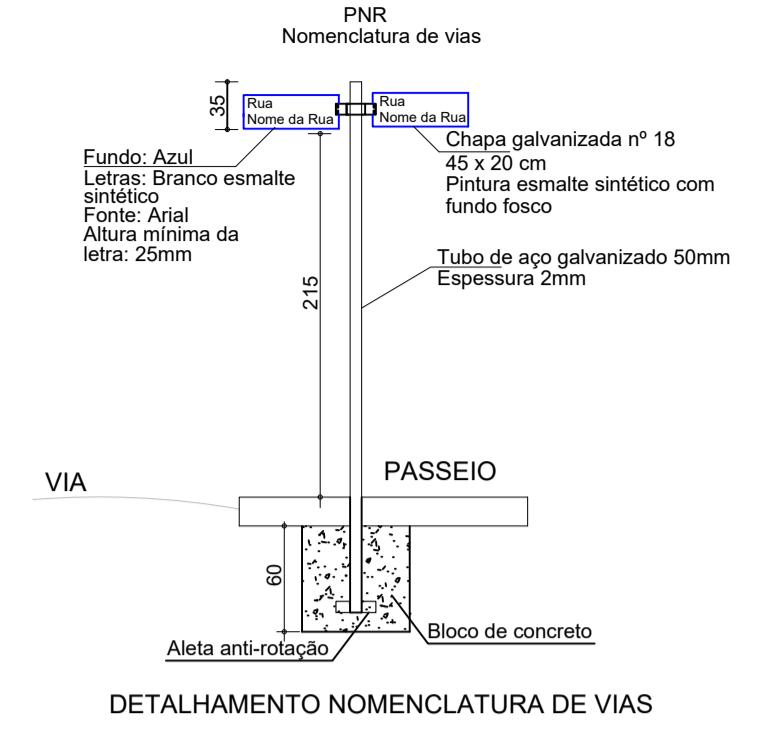
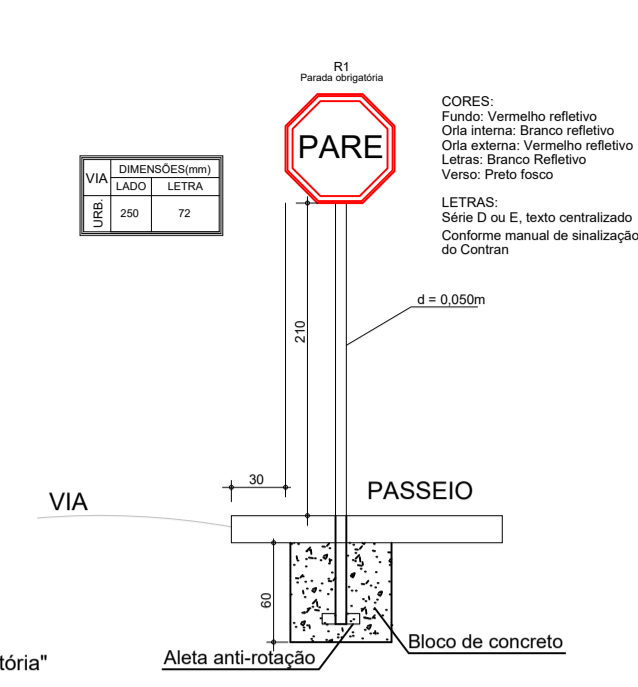
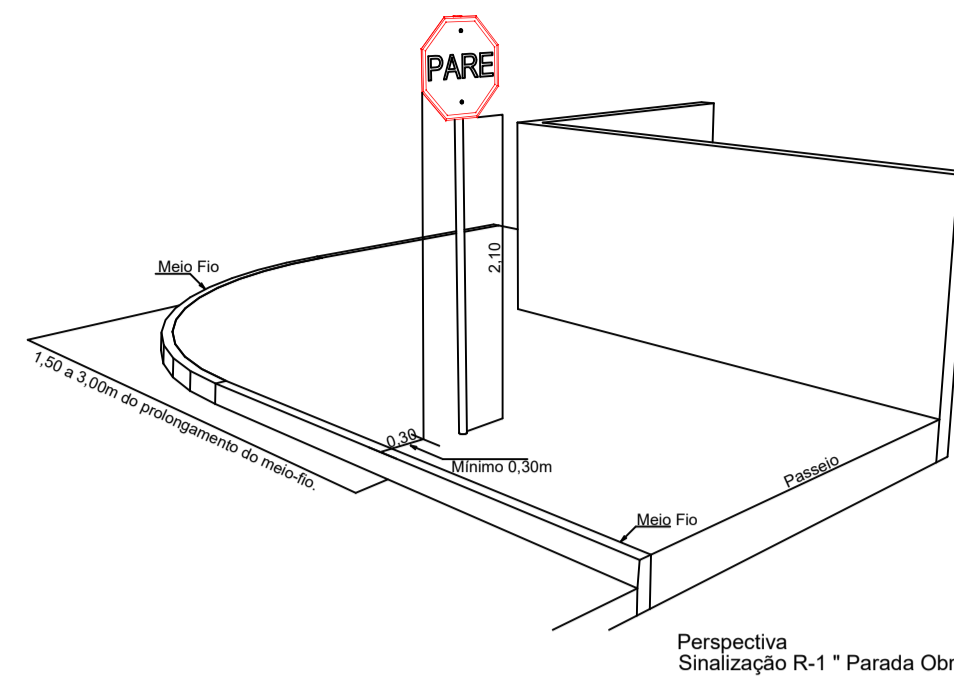
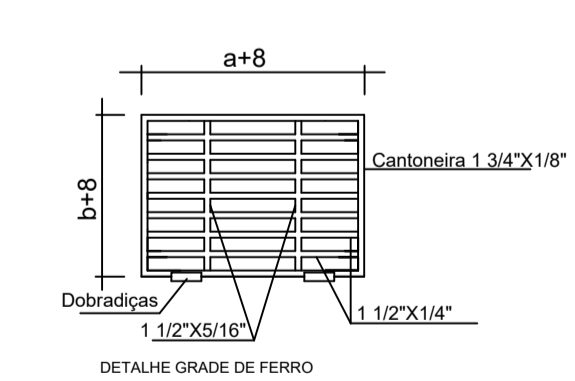
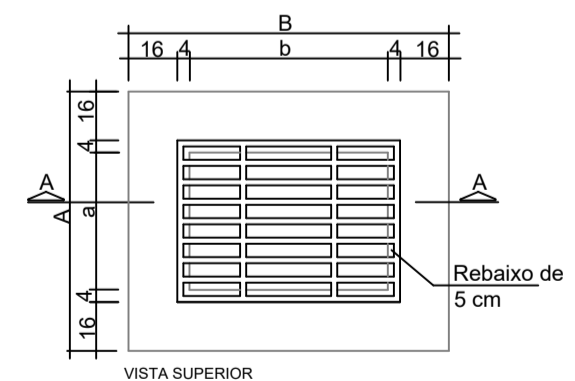

Dimensões da tampa				
D(cm)	a(cm)	b(cm)	A(cm)	B(cm)
40, 60, 80	50	70	90	110

Dimensões da boca				
D(cm)	a(cm)	d(cm)	C(cm)	D(cm)
40	50	70	90	110
60	70	90	110	130
80	90	110	130	150

Nota: Para os tubos de 40cm, as bocas de lobo terão dimensões mínimas de 90x110cm.

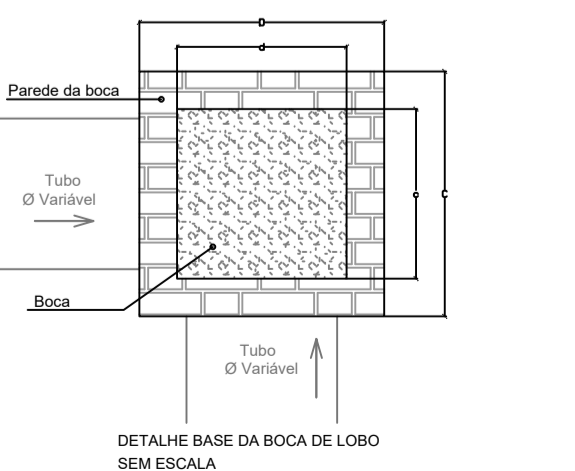
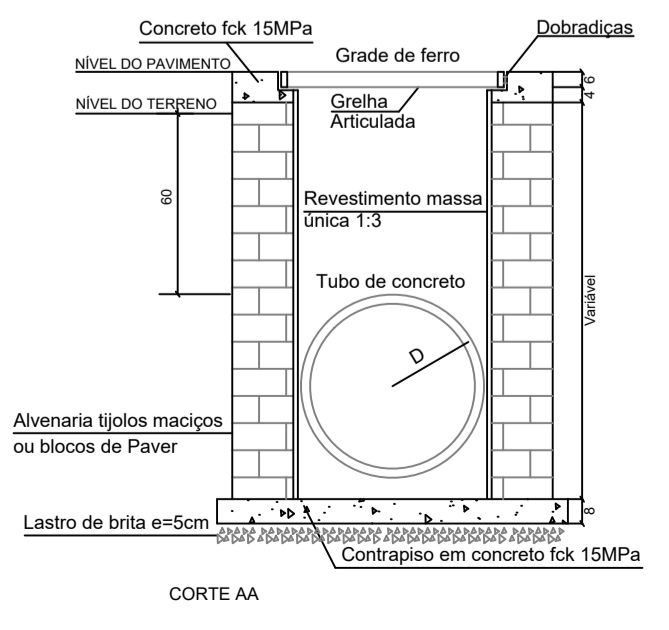

DETALHAMENTO BOCA DE LOBO
Sem escala

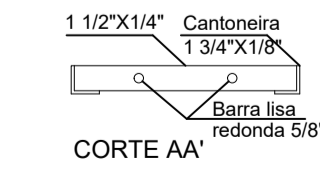

LEGENDA	
	Boca de lobo e drenagem a executar
	Trecho a pavimentar sobre pedra rachão
	Meio-fio pré-moldado a executar
	Poste existente a manter
	Entrada de veículos

QUANTITATIVOS	
Boca de lobo completa	04 unidades
Tubo em concreto Ø40cm	128,00 m
Pavimentação asfáltica sobre base de brita graduada (3cm - acostamento)	553,35 m²
Pavimentação asfáltica sobre base de brita graduada (6cm - pista de rodagem)	1080,37 m²
Placa de "PARE"	01 unidades
Placa de nomenclatura de rua	01 unidades



OBRA: Pavimentação asfáltica Rua Paulo Marques			
PROPRIETÁRIO: MUNICÍPIO DE SÃO DOMINGOS CNPJ: 83.009.894/0001-08	ESCALA: H: 1/1000 V: 1/200	DATA: 05/2024	PRANCHA: 01/01
RESP. LEVANTAMENTO: MAICON GENTIL POLESE ENGENHEIRO FLORESTAL - CREA/SC: 156.616-5	RESP. TÉCNICO: AMANDA CUNICO CARNEIRO ENGENHEIRA CIVIL - CREA/SC: 163.289-6		